

The background of the page is a solid light green color. Overlaid on this are several large, overlapping, curved shapes in a darker shade of green. These shapes create a sense of depth and movement, resembling stylized hills or abstract architectural forms. The curves are smooth and fluid, dominating the left and center portions of the page.

General Fittings



Material

UliStrut® fittings comply with BS1449 Part1:1983 or BS4360:1972 and are manufactured from hot-rolled, pickled and oiled steel plates, strip or coil. They have a minimum yield stress of 170N/mm² as specified in BS6946:1988.

All fittings are manufactured from 6mm thick material unless specified otherwise. UliStrut® fittings can also be obtained in stainless steel.

Finishes

The standard finish is hot-dip galvanized to ASTM A123:1989/EN ISO 1461:1999(E) which supersedes BS729:1971 unless otherwise. Other finishes are available upon request.

Applications

The fittings illustrated show only one application for each item. However, more than one application is possible on most cases. Hole diameters and slot widths are 14mm for M12 screws, unless otherwise indicated. Fasteners must be ordered separately as they are not included with the fittings.

Dimensions

All dimensions used in this section are in millimeters (mm) unless otherwise stated.

Design Screw Torque

BOLT SIZE	M6	M8	M10	M12
Torque in Nm for Grade 4.6 screws	5	11	22	38
Torque in Nm for Grade 8.8 screws	7.5	28	55	95

Design Load

A safety factor of 2 applies to all design loads in the section. The design load data and figures illustrated are safe working loads with reference to M12 grade 8.8 electro-galvanized bolts and hardened M12 Spring Nuts fitted to mild steel UliStrut® channels.

Design Load Data



UL1068	UL1026	UL1068	UL1326	UL1326
Safe working load applied as indicated				
kg	kg	kg	kg	kg
640	640	160	160	1280

UL1713	UL1130/UL1131	UL1186-45°	UL1546-45°	UL1331/UL1332
Safe working load applied as indicated				
kg	kg	kg	kg	kg
130	390/490	Compression 640 Tension 60	Compression 640 Tension 60	760

1. Both ends of beams supported.
2. Loads are for: UL1000 2.5mm thick channels.
M12 hardened spring nuts.
3. Safety factor = 2 based on ultimate strength of connection.

Flat Plate Fittings

UL1062, UL1063, UL1064

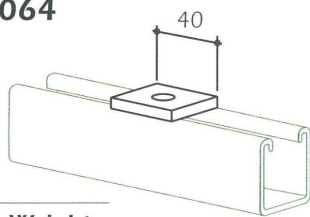

Product Number	Bolt Size	Hole Ø	Weight g
UL1062	M8	9mm	73
UL1063	M10	11mm	72
UL1064	M12	14mm	69

UL1065

Weight: 157g

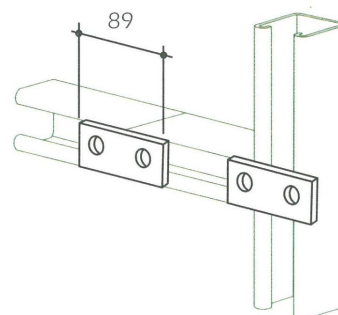

UL1066

Weight: 243g

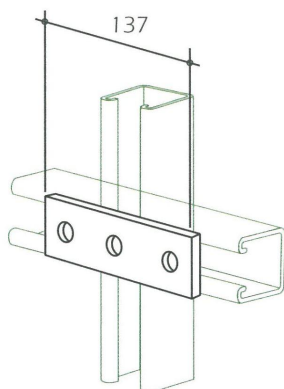

UL1067

Weight: 330g

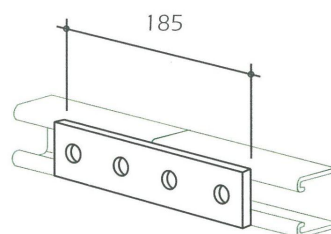

UL1036

Weight: 250g

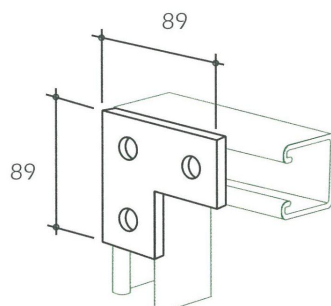

UL1031

Weight: 339g

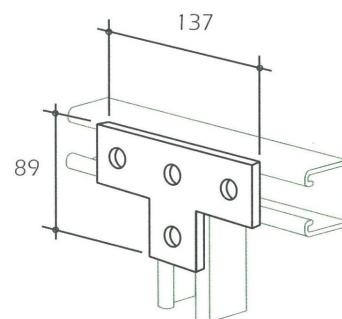

UL1028

Weight: 425g

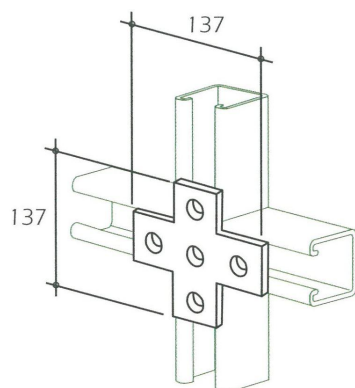

UL1358

Weight: 450g

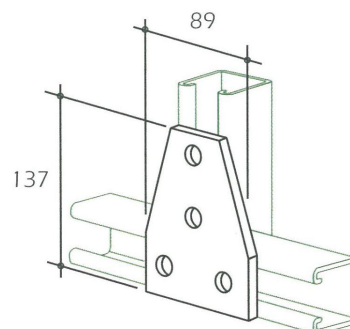

Hole Ø & Slot Width	Hole Spacing	Width	Thickness
14mm	20.5mm From End 48mm on Centre	40 or 41mm	6mm

Angular Fittings



UL1068

Weight: 159g

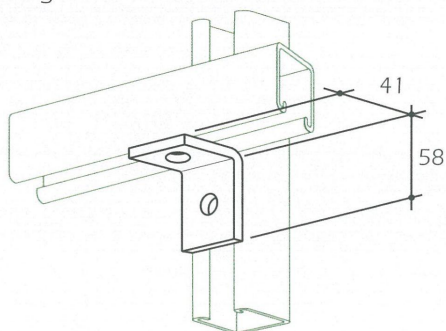

UL1026

Weight: 157g

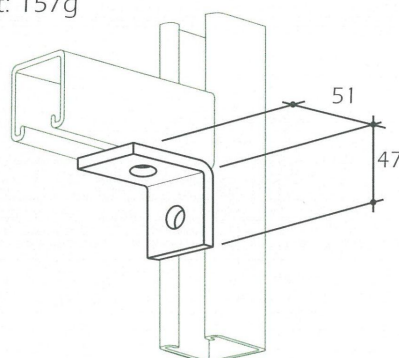

UL1326

Weight: 242g

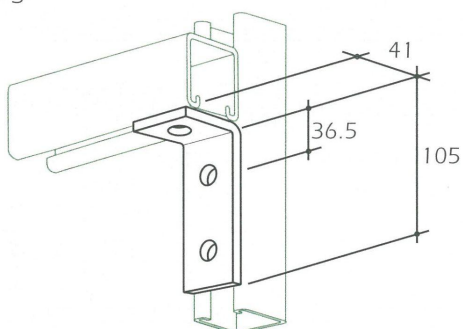

UL1325

Weight: 327g

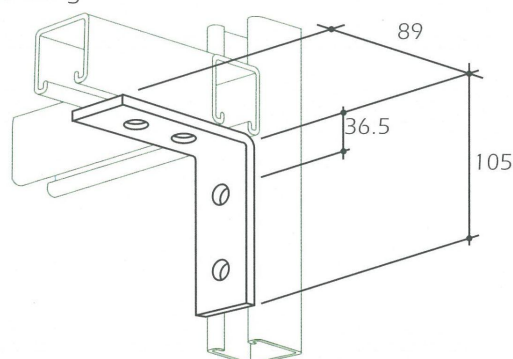

UL1749

Weight: 194g

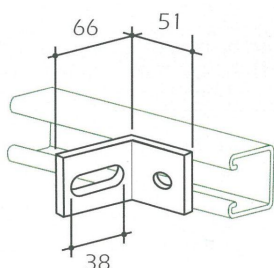

UL1747

Weight: 263g

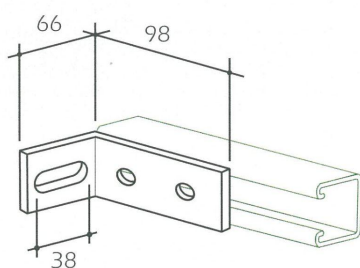

UL1359

Weight: 458g

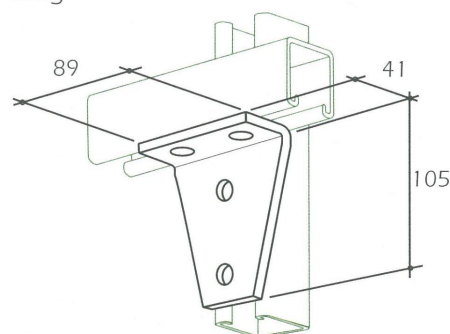

UL1130, UL1131

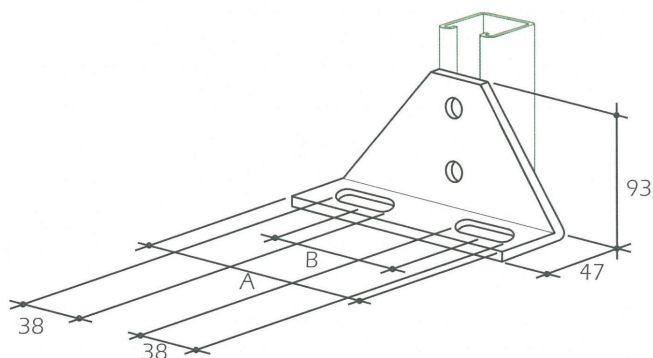

Product	A	B	Weight
	mm	mm	g
UL1130	168	102	760
UL1131	219	152	976

Hole Ø & Slot Width	Hole Spacing	Width	Thickness
14mm	20.5mm From End 48mm on Centre	40 or 41mm	6mm

Angular Fittings



UL1713

Weight: 384g

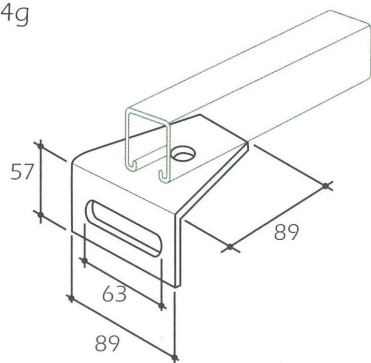

UL1186-45°

Weight: 256g

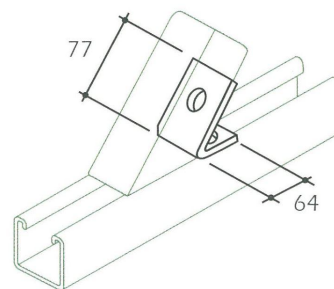

UL1546-45°

Weight: 246g

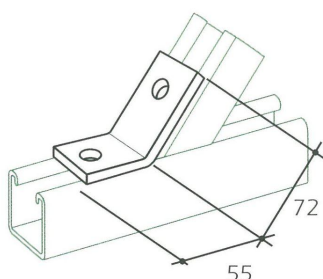

UL1033

Weight: 342g

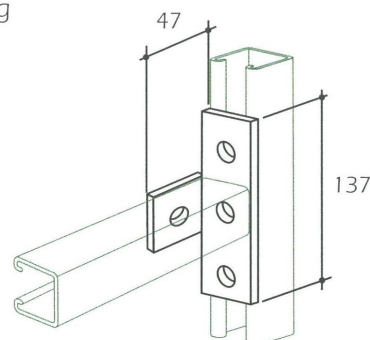

UL1035

Weight: 342g

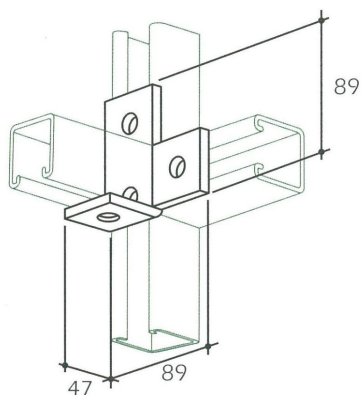

UL1034

Weight: 342g

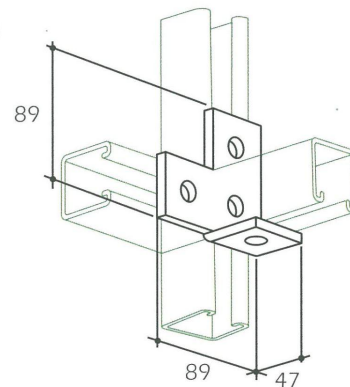

UL1331

Weight: 432g

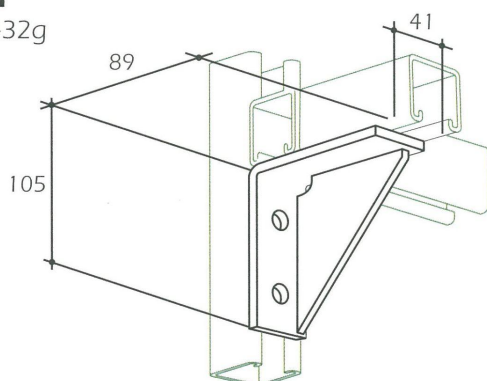

UL1332

Weight: 432g

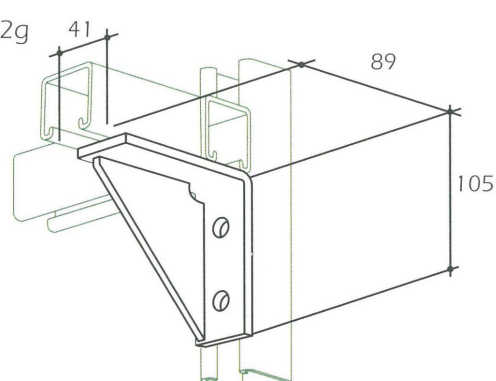

Hole Ø & Slot Width	Hole Spacing	Width	Thickness
14mm	20.5mm From End 48mm on Centre	40 or 41mm	6mm

"U" Shape Fittings



UL4376

Weight: 358g

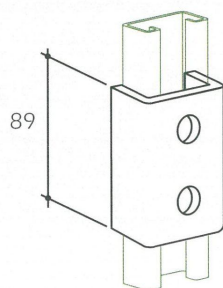

UL4376-A

Weight: 558g

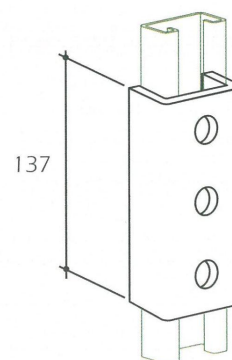

UL4377

Weight: 760g

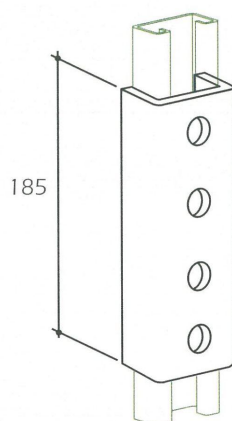

UL1377

Weight: 1100g

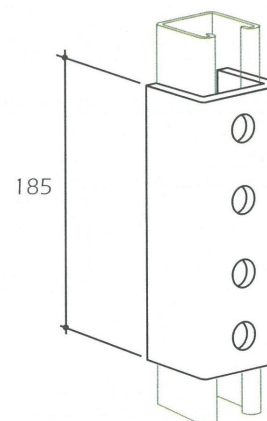

UL4047

Weight: 284g

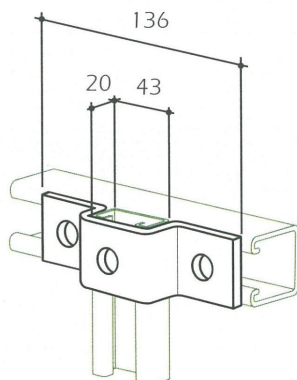

UL1047

Weight: 358g

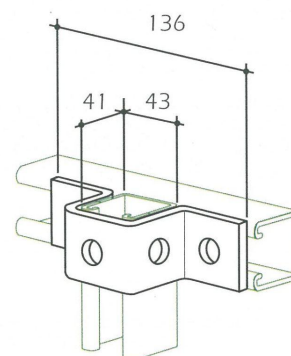

UL1737

Weight: 530g

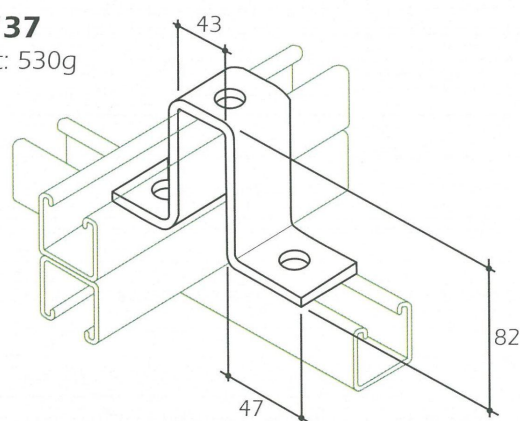

UL2346

Weight: 726g

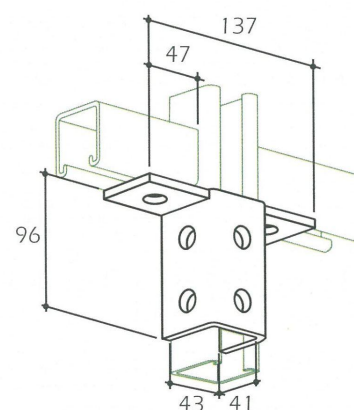

Hole Ø & Slot Width	Hole Spacing	Width	Thickness
14mm	20.5mm From End 48mm on Centre	40 or 41mm	6mm

"Z" Shape Fittings



ULZB01 (N)

Weight: 160g

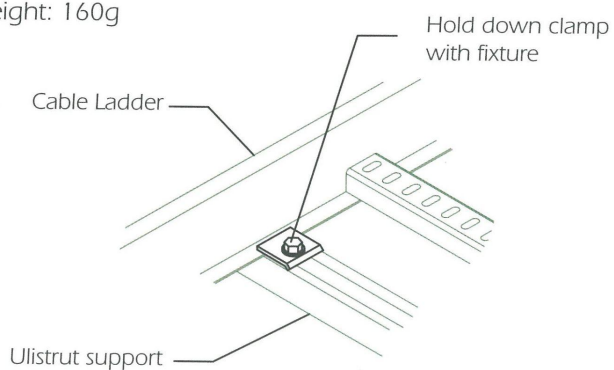

UL4045

Weight: 180g

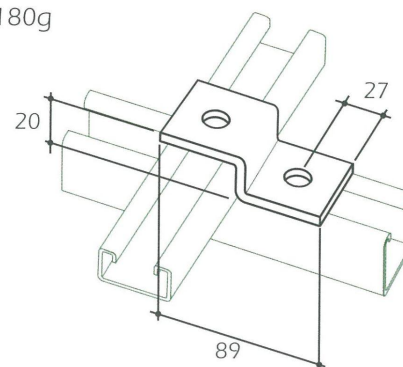

UL1045

Weight: 212g

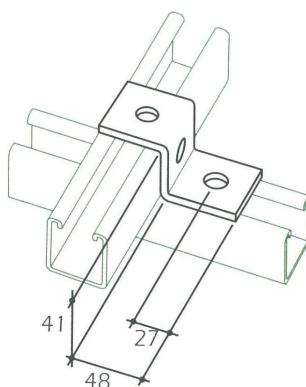

Beam Clamps

UL1272

Weight: 188g

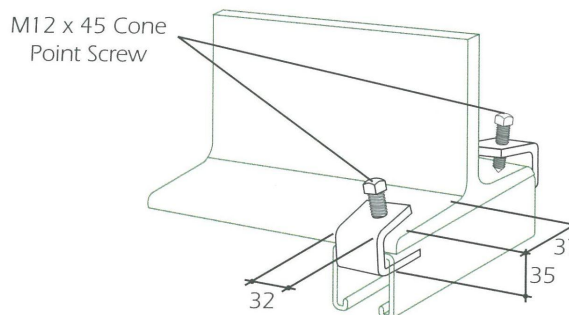

Design Loading Data	
Product Number	Design Load per Pair
mm	kg
UL1272	160
UL1271	180
UL1796	440

UL1271

Weight: 466g

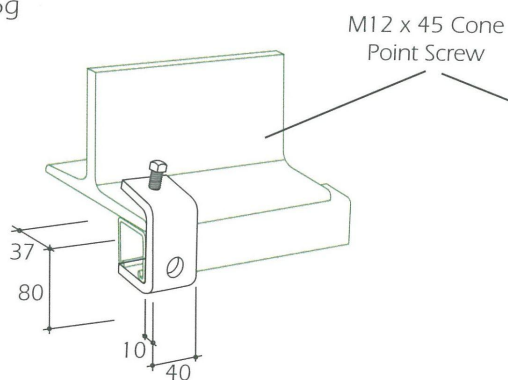

UL1796

Weight: 466g

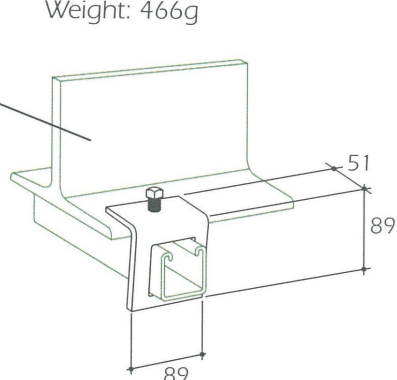

Hole Ø & Slot Width	Hole Spacing	Width	Thickness
14mm	20.5mm From End 48mm on Centre	40 or 41mm	6mm (unless otherwise stated)

Beam Clamps



UL1379S

Weight: 380g

M12 x 35mm
Set Screw Included

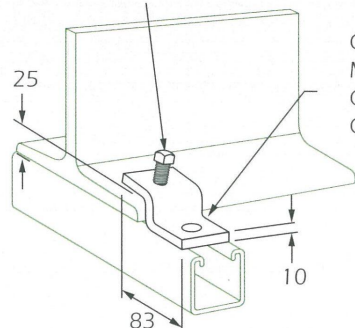

Clamp Requires
M12 x 25mm Hex Head
Cap Screw and M12
Channel Nut Not Included.

Design Load Each (Use in Pairs Only)

P/N	kN
UL1000	2.7
UL1100	2.2

UL1386

Weight: 230g

Clamp Requires
M12 x 35mm
Hex Head Cap Screw
and M12 Channel
Nut Not Included.

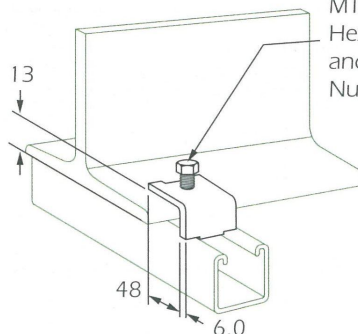

Design Load Each (Use in Pairs Only)

P/N	kN
UL1000	2.7
UL1100	2.2

UL2785

Weight: 370g

M10 Hex Nuts and
"U" Bolt Included

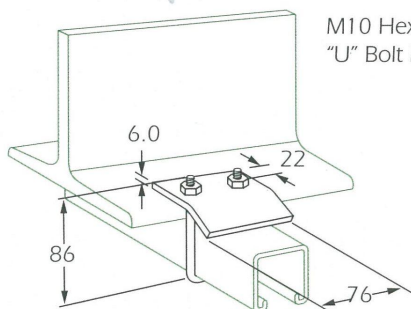

- Design Load: 500kg
- Use in Pairs Only
- For use with Beams up to (19.1), Thick Flanges and with Channels UL1000, UL3300 and UL3301

UL2786

Weight: 410g

M10 Hex Nuts and
"U" Bolt Included.

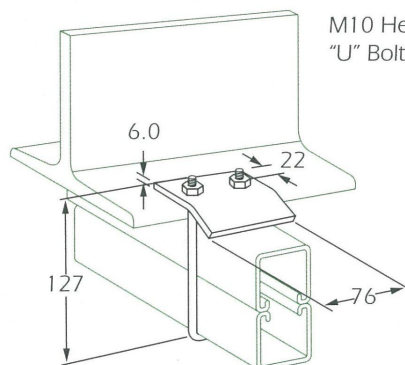

- Design Load: 500kg
- Use in Pairs Only
- For use with Beams up to (19.1), Thick Flanges and with Channels UL1001



Post Base Plates

UL2072

Weight: 1.31kg

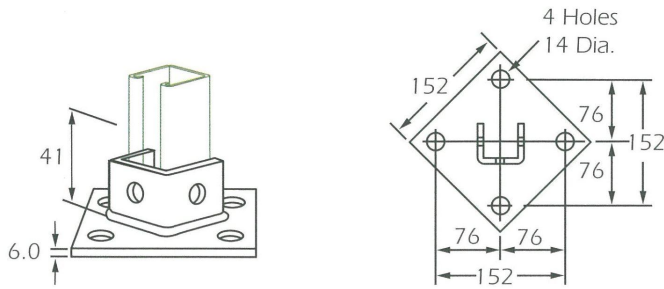

UL2072A

Weight: 1.66kg

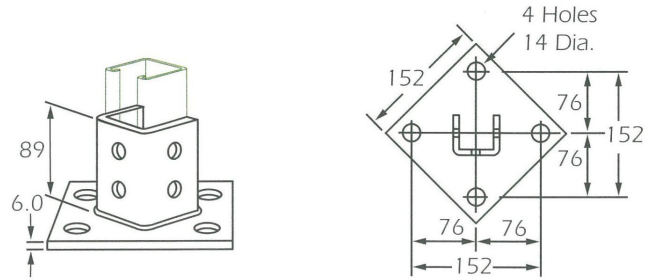

UL2073

Weight: 1.68kg

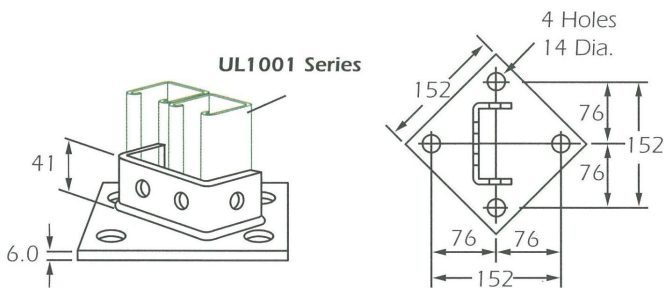

UL2073A

Weight: 2.05kg

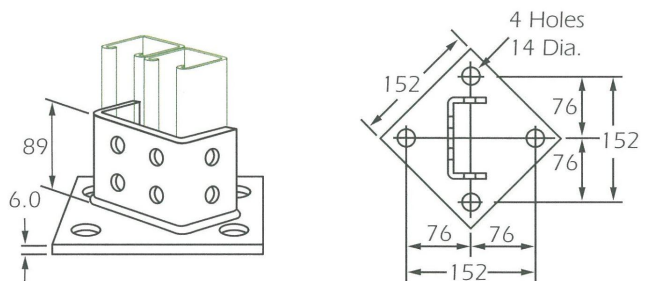

UL2074

Weight: 1.31kg

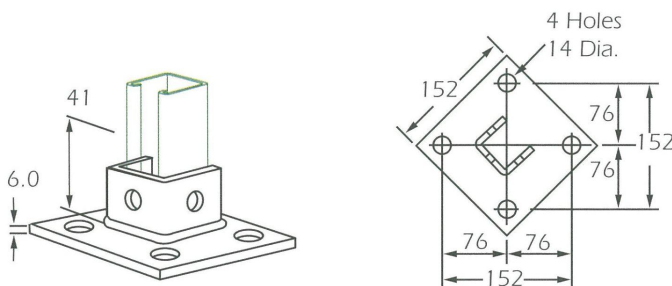

UL2074A

Weight: 1.66kg

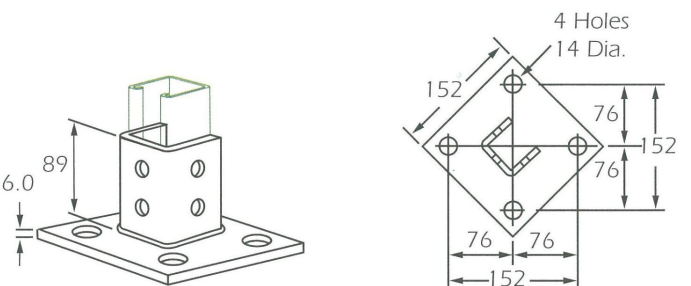

UL2075

Weight: 1.68kg

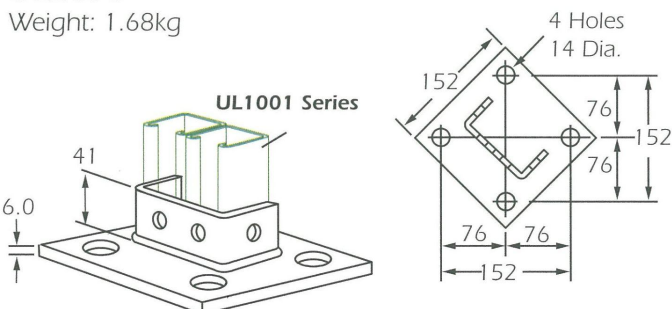

UL2075A

Weight: 2.05kg

